

# Collegium of Pecuniary Damages Experts

Friday, April 26 – Saturday April 27, 2019

## 2019 Annual Conference & Business Meeting

The Westin Lake Las Vegas Resort & Spa  
101 Montelago Blvd, Henderson, NV 89011

April 25<sup>th</sup>, 2019:  
Pre-Conference Social Gathering

April 26<sup>th</sup>, 2019: (Sessions #1 – #4)  
April 27<sup>th</sup>, 2019: (Sessions #5 – #8)  
Conference Room: Kenitra AB



<http://www.cpde.info/index.html>

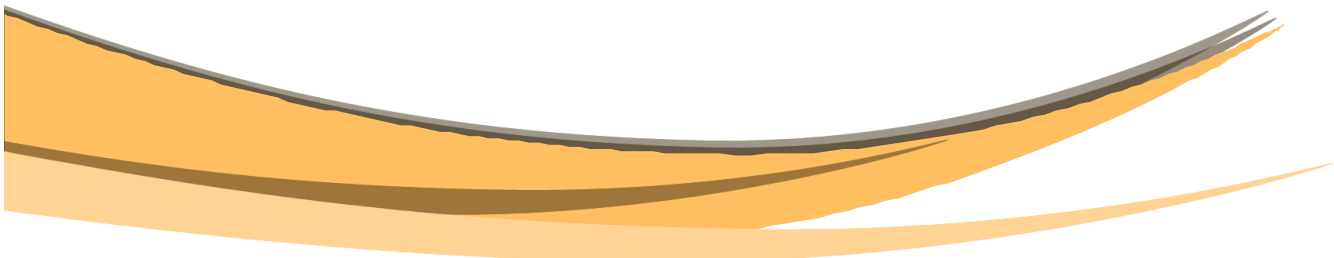

# Thursday - April 25<sup>th</sup>, 2019

## Pre-Conference Social Gathering

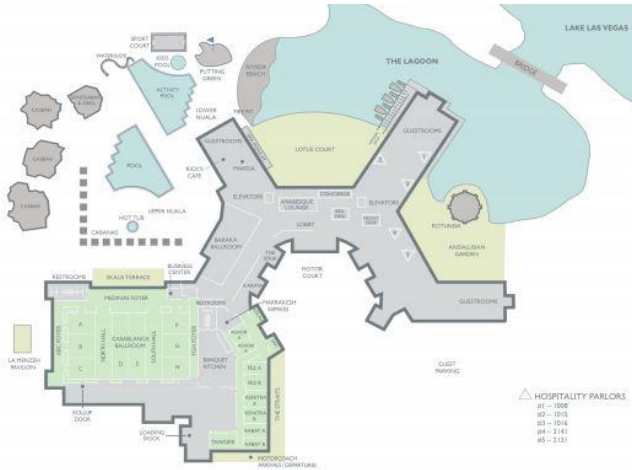

Anyone that is in town and wanting to gather with others for a no host meeting will be at the TBD in the Westin Lake Las Vegas Resort & Spa at 8:30pm.

# Friday - April 26<sup>th</sup>, 2019

## Sessions 1 – 4 (9AM - 3:50PM)

### Session #1: 9:00 - 10:40

*Practice Issues & Notes*

Robert Male

### Session #2: 10:50 - 11:50

*Atlanta Federal Wage Tracker Statistics*

Thomas Borzilleri

### (Lunch 11:50am - 1:00pm)

### Session #3: 1:00 - 1:30

*Excel: Using Published Model Parameters and Creating Your Own Models from Published Data*

Rick Gaskins

### Session #4: 1:40 - 3:50

*Wish I Hadn't-True Confessions of our own and our opponents worst (&/or funniest) professional boo-boos*

Gregson Parker, Tom Roney,  
Oscar Padron

## **Social Get-Together (Room TBD)**

4:30 - 6:00PM

# Saturday - April 27<sup>th</sup>, 2019

## Sessions 5 – 8 (9AM - 4:50PM)

### Session #5: 9:00 - 10:50

*Panel Discussion – LCP's and Medical Price Inflation Forecasting*

Scott Gilbert, Thomas Roney,  
Joseph Rosenberg, Thomas  
Borzilleri & Rick Gaskins

### Session #6: 11:00 - 11:50

*Discount Rates ... etc.*

Rob Schlegel & Oscar Padron

## Annual Business Meeting 12 noon - 1:00

### (Lunch 1:00 - 2:00pm)

### Session #7: 2:00 - 3:20

*New Tax Act and Issues for FE's*

Oscar Padron

### Session #8: 3:30 - 4:50

*Inverted Yield Curve Issues & Discussion*

Mark Moore

## **Social Get-Together (Room TBD)**

5:00-6:30PM

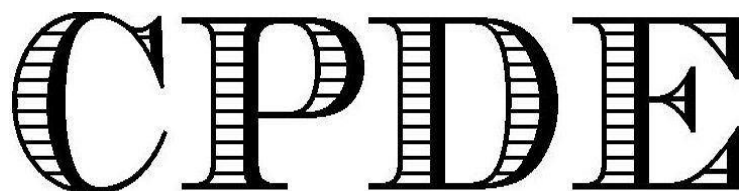

Collegium of Pecuniary Damages Experts